



baja designs®
THE SCIENTISTS OF LIGHTING

22-on Polaris RZR Pro-R Roof Kits (44-8091, 44-8092, 44-8093, 44-8094)



2950 Norman Strasse • San Marcos • CA • 92069

Phone 760-560-2252 X3 • Fax 760-560-0383

info@bajadesigns.com • www.bajadesigns.com



baja designs®
THE SCIENTISTS OF LIGHTING

LIMITED LIFETIME WARRANTY

Baja Designs proudly offers a LIFETIME WARRANTY against manufacturer's defect on all the products that we manufacture.

These are comprehensive warranties; other than the exclusions below – you're covered. If your LED or HID bulb burns out, you're covered. Additionally, cutting off our connector or changing your lenses does not automatically void your warranty.

Exclusions:

Installation errors, abuse, misuse or crash damage. You must be the original owner of the product and can supply proof of purchase.

Baja Designs manufactures its own products as well as resells products manufactured by others. Baja Designs makes no express or implied warranties on products not manufactured by Baja Designs including without limitation any warranties or merchantability and fitness for a purpose. We will, however, pass on all warranties made by the manufacturer, who has sole responsibility for performing such warranties.

Baja Designs will pay the freight if your product is less than 90 days old, otherwise defective products must be returned to Baja Designs, Inc., freight prepaid. At our option, we will repair or replace items in question and return them at no charge. If the identical product is no longer available, we will replace with a similar product of equal value. Baja Designs Inc. will not be responsible for any indirect or consequential damages in connection with defective merchandise.

Items purchased through a Baja Designs authorized dealer must be returned through the dealer. Only available on LED auxiliary lights and product must be in sellable condition at MSRP. Product that has been damaged in any way after the original purchase date will be excluded from this guarantee.

Indemnification:

Buyer hereby acknowledges off-roading, racing and driving at night are dangerous activities and that the products and/or supplies purchased from Baja Designs are used in an inherently dangerous activity that may endanger life and limb; and in no event shall the seller, or seller's heirs and assigns, be held liable for consequential damages, nor shall seller's liability on any claim for damages arising out of or connected with the sale, delivery, or use of purchased products and/or supplies exceed the purchase price of the products and/or supplies.

Buyer is responsible for ensuring that it uses the products (and its vehicle) in accordance with all applicable laws, regulations, guidelines, and standards of care. Buyer acknowledges that some products may only be used when off-roading, and Buyer will comply with all vehicle and road safety guidelines. Buyer is solely responsible for (and will indemnify and hold Bestop harmless for) any claims, losses, damages, fines, fees, costs, or other amounts arising out of Buyer's non-compliance with these provisions.

Tools Required

*T-40 Torx

* 7/16" wrench

*7/16", 10mm socket

To begin, make sure the vehicle is in park, on level ground and the parking brake is engaged.

1. Using a T40 Torx driver, remove the two forward roof bolts on the passenger side of the vehicle. Remove the U-nuts from underneath the roof that the bolts tightened into.

2. Locate the passenger side vehicle specific bracket and apply a piece of the included EPDM tape around each roof mounting hole on the bottom side of the bracket. Cut the excess material and create a slot to allow the bolt to pass through.

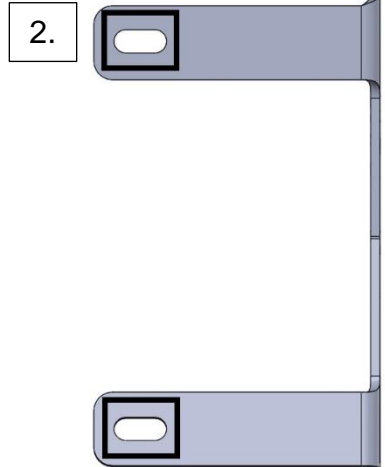
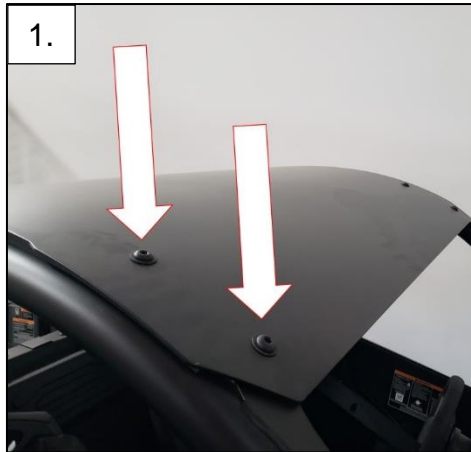

3. With a 10mm socket and T40 Torx, install the passenger side light bar bracket to the roof using the 2 removed T40 bolts and the included nyloc nuts and washers. Leave the bolts loose to allow for adjustment. Repeat steps 1-3 for the driver side of the vehicle.



For OnX6+ and S8 lights

4. With an assistant, install the light bar into the vehicle specific brackets using the included hardware and 7/16" wrench. Center the light then tighten the 2 rear T40 Torx bolts. Remove the light, tighten the front T40 Torx bolts then reinstall and

For XL Linkable lights

5. Place the 7 XL Linkable onto a soft work surface. With the Allen wrench provided in the XL Linkable parts bag, remove the top and bottom bolts of one of the center pair of links. On the center light, remove the housing bolts with the provided Allen wrench. **(See instructions included with the XL Linkable)**

6. Locate the preload extension brackets with hardware (seen in photo 6). With the 7/16" wrench and socket, attach the rubber bump as shown to the base support bracket (#8 in Figure 3 of the XL Linkable Instructions). With the longer bolts in the support bracket parts bag, reattach the link to the light with the extension bracket (#14 in Figure 3 of the XL Linkable Instructions) in between the link and the light housing. Leave the bolts in the slots slightly loose for

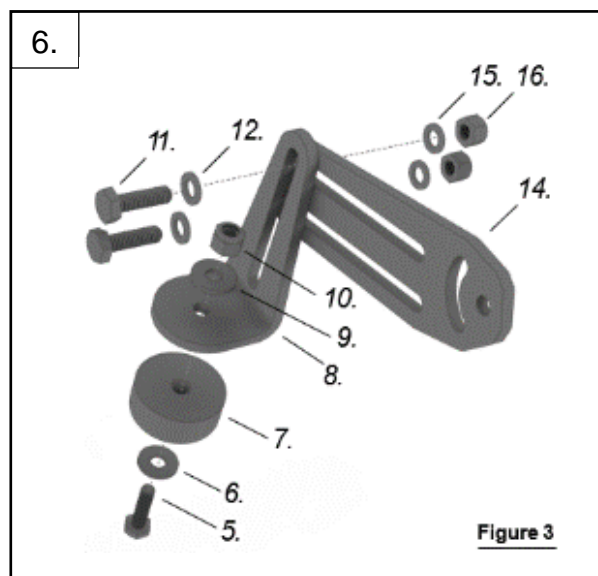

Figure 3

7. With the provided Allen wrench, replace the bolts from step 5 and reassemble the Linkable light bar. One at a time, loosen each pair of links (7b) and adjust so the edges are parallel as shown (7a). Tighten. Remove the outermost links as they will not be needed.

8. With the included $\frac{1}{4}$ "-20 hex head bolts, washers and $\frac{7}{16}$ " wrench, mount the lightbar to the roof brackets. Tighten.

7b.

Adjustment Bolts Top and Bottom

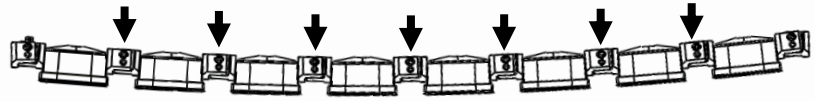

7a.

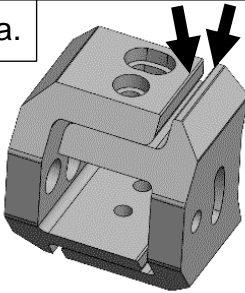

8.

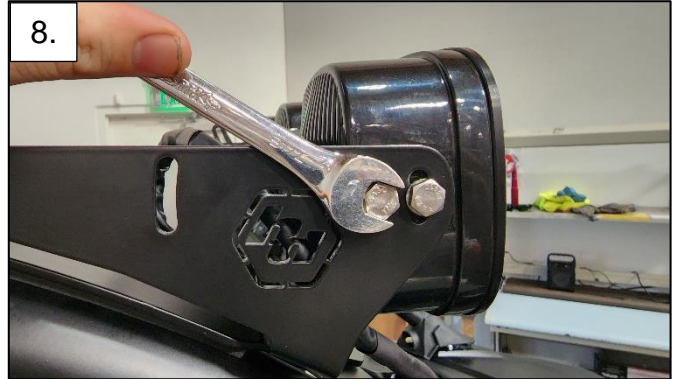

9. Center the light by sliding the roof brackets left or right. Tighten the rear roof bolts with the T40 Torx driver and without bumping the brackets, remove the XL Linkable.

10. Tighten the front roof bracket bolts. Reinstall and aim the XL Linkable. Tighten the outer mounting bolts.

10.



11. Open the dash center console and remove the console insert. Locate the pulse bar and remove one of the pulse bar caps. Plug in the included wiring harness pulse bar connector to the slot.

12. Locate the rocker switch on the wiring harness, take a photo of the wiring and unplug the spade connectors. From the passenger side footwell, reach up into the dash and locate the back of the desired rocker switch punchout and carefully press it out.

11.



12.



13. Run the switch wires through the dash to the desired switch location. Plug in the switch wires following the reference photo and install the switch into the dash.

14. Run the light plug through the dash and the wire passthrough found on the passenger side firewall. Route the wire up the fender well to the base of the roll cage. Make sure to avoid any hot, sharp, rotating or moving components.

13.



14.

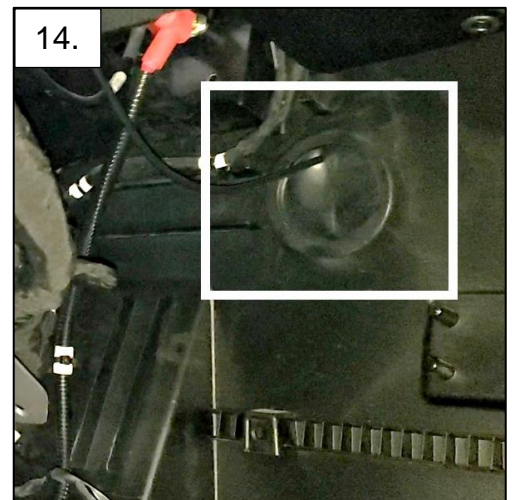

15. Fold back the roll cage boot and fish the light connector up through the boot and out the top. Run the wire up the roll cage to the light securing with zip ties.

16. Plug the wire harness into the light and test the light. Secure excess wire into a service loop and tuck into the dash. Replace the dash center console insert.

15.

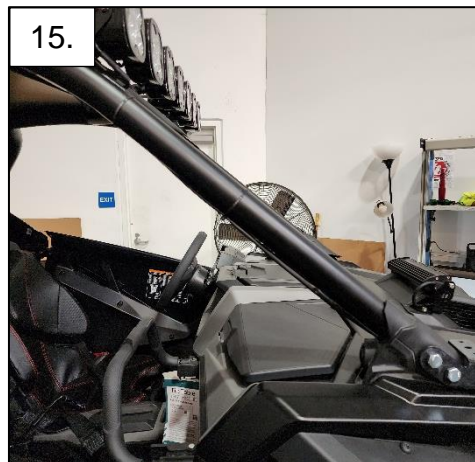

16.



For S8 Backlight

A1. Locate the 2" wire with a male bullet connector. Remove and discard it. Attach the S8 backlight harness male bullet connector to the wiring harness female bullet connector.

A2. Run the backlight wire with the main wiring harness to the light. Open the main harness connector and insert the wire terminal into slot C (shown in photo BL2). Make sure the wire terminal clicks into place and close the connector lock.

A1.

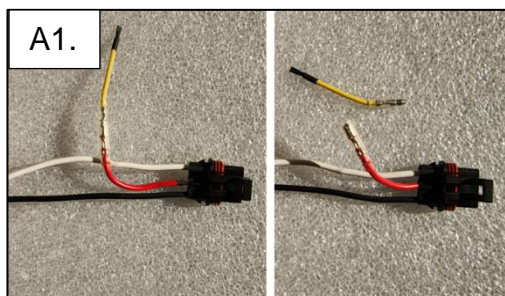

A2.

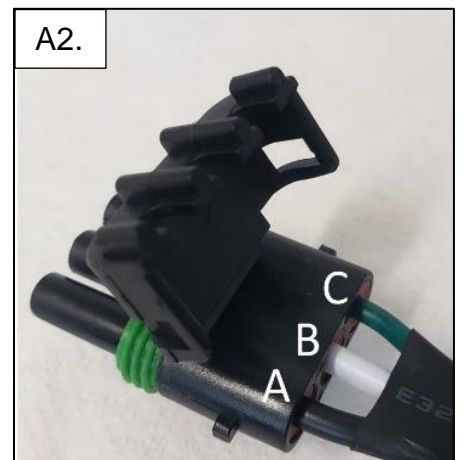

*Tie all wires away from sharp, hot, and/or rotating components.

* Re-torque all the fasteners after 100 miles.

*Your install is now complete! Thank you for choosing Baja Designs.